

SPEAKON Y CONNECTORS

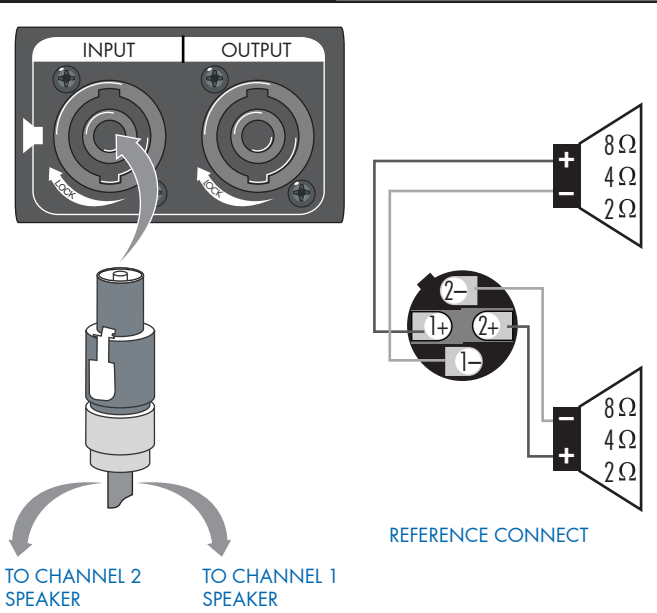

Speakon Outputs

The upper Speakon jack has both Channel 1 and Channel 2 outputs, so it is especially useful for parallel, bi-amp, or BRIDGE mono operation. The other Speakon carries only Channel 2's output. See the illustrations at above.

SPEAKON CONNECTORS

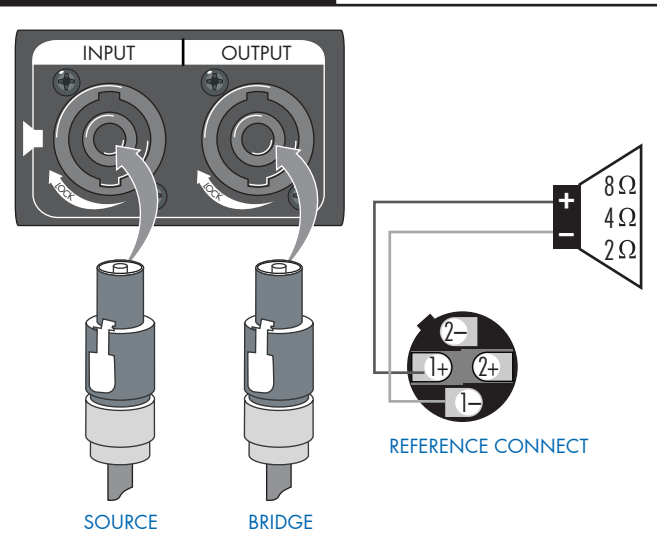

Source (INPUT) comes from the output source of the active/powered speaker while the bridge (OUTPUT) connects to the passive/non-powered speaker.

NOTE A speakon cable is required to connect the "OUTPUT" of the active/powered speaker to the "INPUT" of the passive/non-powered speaker. Please order the speakon cable from our authorized dealers.

1. HOW TO CONNECT SPEAKERS

This procedure is how to set up the line array loudspeaker in the active/powered subwoofer.

- 1 Place the subwoofer on the floor, preferably an even surface.
- 2 Place the male ¼ inch of the linkable speaker to the female ¼ inch on top the subwoofer at 45° counterclockwise. Be sure to fully insert it into the socket to assure stability and a good connection.
- 3 Once inserted, turn clockwise 45° to lock the linkable speaker in.
- 4 For additional line array speakers: Place the male ¼ inch of the top speaker to the female ¼ inch on top the linkable speaker at 45° counterclockwise. Be sure to fully insert it into the socket to assure stability and a good connection.
- 5 Once inserted, turn clockwise 45° to lock the speaker in.

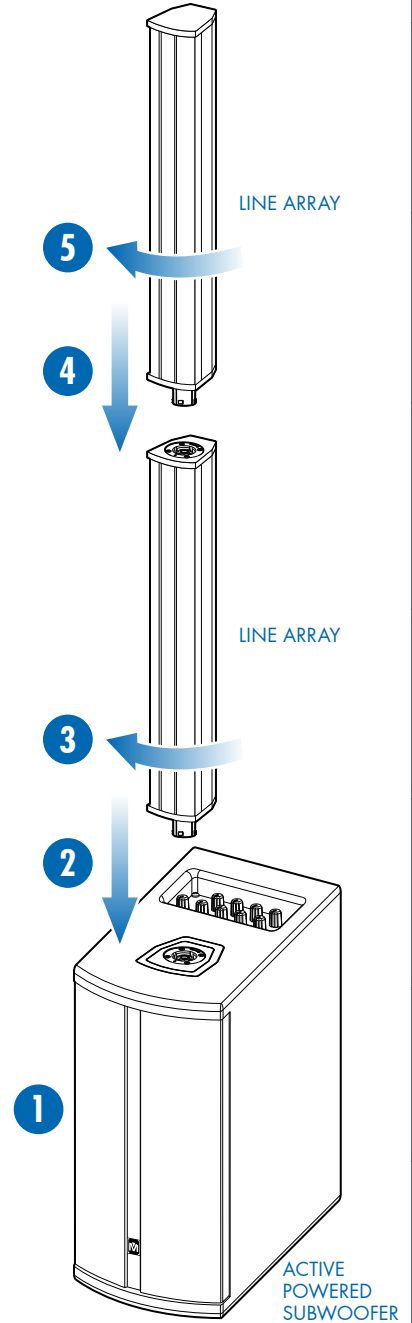

2. PLACING THE SPEAKER ON THE FLOOR TO MONITOR SINGING

This speaker can be placed on the floor to perform the vocal monitoring function for live singing experience. It can also be used for business conference, coffee shop and church, etc.

